

One single procedure for your crown cementations

Zirconia, Lithium Disilicate or Metal. No primers required.
One single procedure regardless of the restorative material.

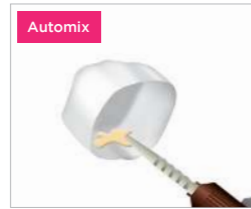

Conditioning the crown.*
* Refer to "Conditioning the prosthetic restoration".



Apply the cement to the crown.



Place the crown.



Light-cure for 2 to 5 seconds or chemical-cure for 2 to 4 minutes, then remove the excess cement.



Maintain isolation for 5 minutes.*
* For a translucent restoration, light-cure.

Conditioning the prosthetic restoration

Follow the instructions for use of the restoration material.
In the absence of specific instructions, we recommend the following procedure:

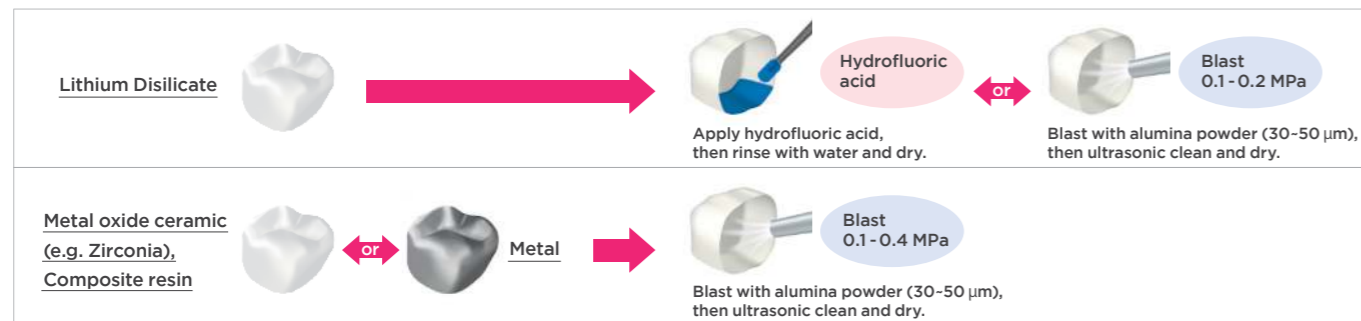

PANAVIA™ SA Cement Universal Automix

- Universal (A2)
- White
- Translucent
- Content: 1 syringe:
- Paste A and B: 8.2 g (4.6 mL), Mixing Tip: 20 tips

Kuraray Noritake Dental Inc.

1621 Sakazu, Kurashiki, Okayama 710-0801, Japan

Website www.kuraraynoritake.com

- Before using this product, be sure to read the Instructions for Use supplied with the product.
- The specifications and appearance of the product are subject to change without notice.
- Printed colour can be slightly different from actual colour.

"PANAVIA", "AVENCIA" and "CLEARFIL" are trademarks of KURARAY CO., LTD
"KATANA" is a trademark of NORITAKE CO., LIMITED.

PANAVIA™ SA Cement Universal

NO PRIMERS REQUIRED

Simple, Clean and Versatile



SIMPLE, CLEAN AND VERSATILE

The MDP and LCSi monomer new chemistry:

- Provides high bond strength
- Eliminates additional steps

No primers or additional steps required



The Original MDP monomer creates a strong chemical bond to Metal Alloy, Zirconia, Enamel and Dentine.



The Original LCSi monomer creates a strong chemical bond to Porcelain, Lithium Disilicate and Composite Resin.

Easy Cementation Without Additional Primers

Say goodbye to complicated bonding protocols and simplify your work flow.

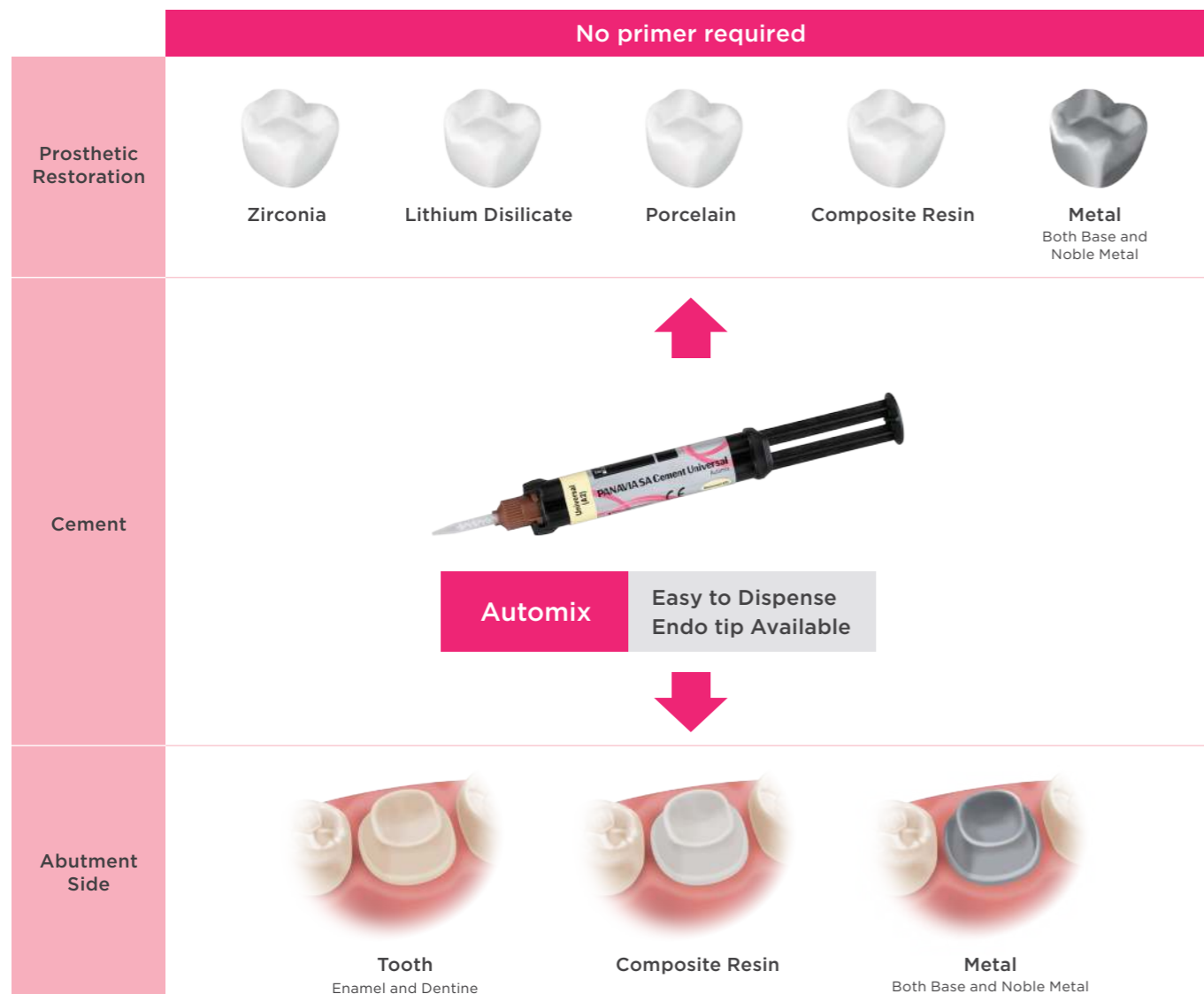

Clean: Fast & Easy Clean-Up

Two options of polymerisation, the same easy clean-up result.

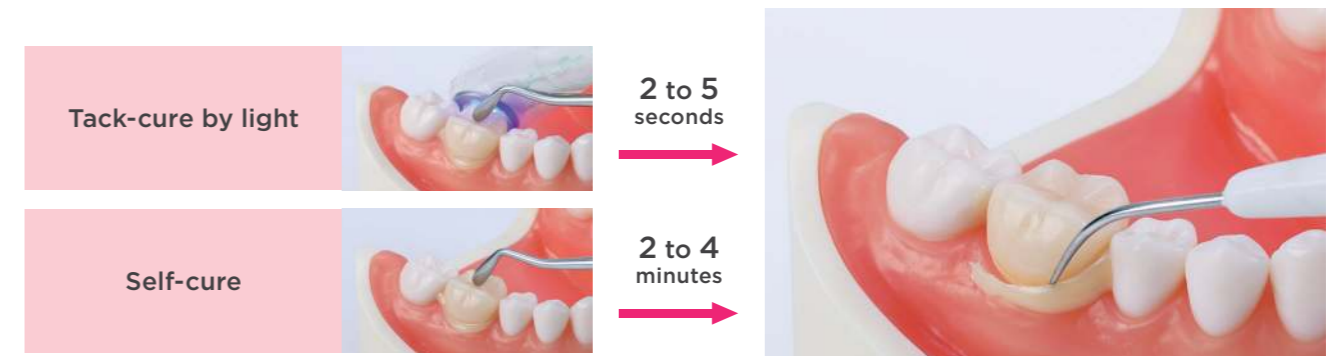

When the cement is used in combination with CLEARFIL™ Universal Bond Quick, the setting time of the excess cement will be faster (1 to 2 seconds).

Easy clean-up that is gentle to the gums and minimises the risk of accidental ingestion.

F-ion release	Storage at Room Temperature	Radiopacity	Film thickness
Contains surface treated sodium fluoride	2-25 °C	Yes	Approx. 16 µm

Shades

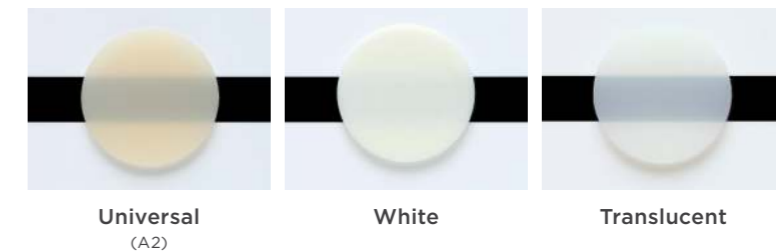

Original MDP Monomer: High Bond Strength

Shear Bond Strength to Restorative Materials

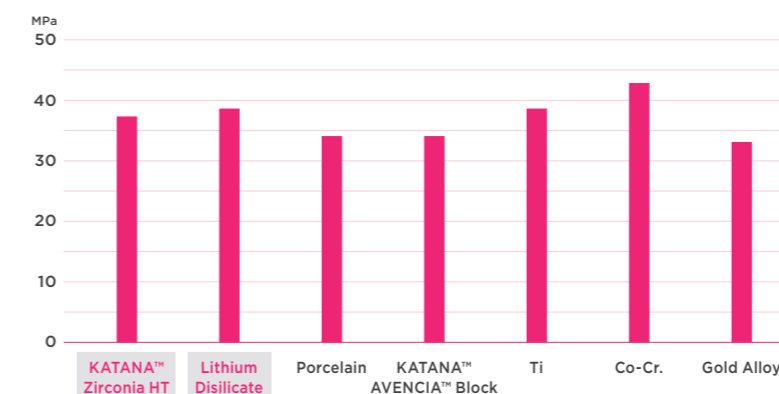

Shear Bond Strength to Tooth Structure

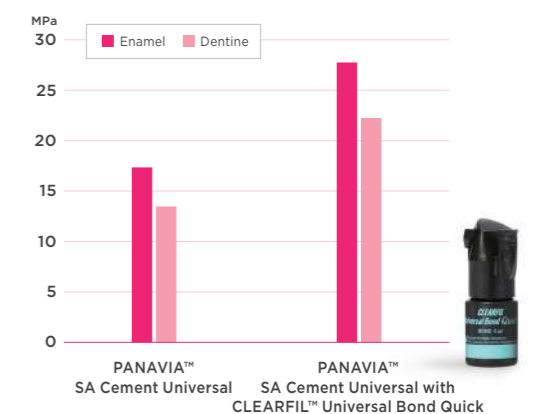

CLEARFIL™ Universal Bond Quick can be used on the tooth structure to enhance the bond strength for cases with poor retention.